

Care and Maintenance

To ensure that your tilt and turn windows function correctly, it is important that the following maintenance procedure is carried out at least once a year:

- Fittings which are important for safety purposes must be regularly inspected to ensure that they are firmly fixed. Where necessary they should be tightened by a suitably qualified person.
- All moving parts and locking points of the tilt and turn fittings must be lubricated.
- Only cleaning fluids that have no effect on the corrosion protection properties of the fittings should be used.

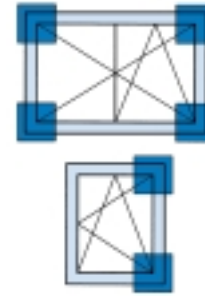

TREND Operating and Maintenance Instructions

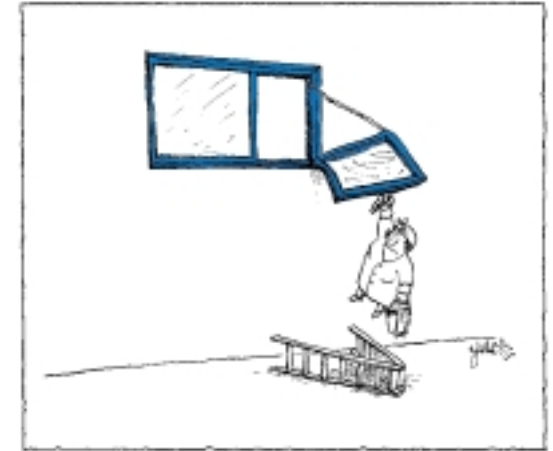

PVCu Windows

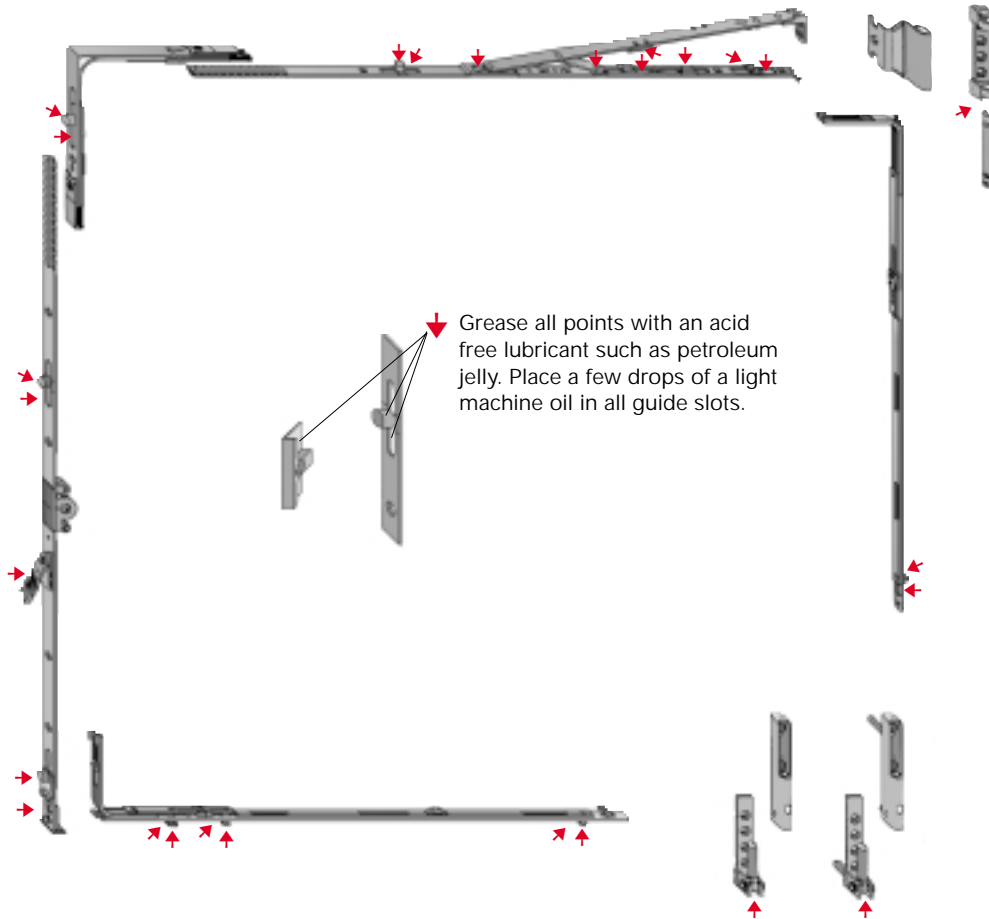

Grease all points with an acid free lubricant such as petroleum jelly. Place a few drops of a light machine oil in all guide slots.

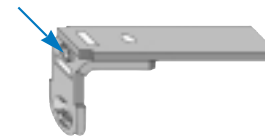

Rebated Scissor Stay:
Maximum protrusion of screw is 1mm.

Stronger contact pressure

Lighter contact pressure



Advice on your Windows

- ▶ Your windows have been fitted with high quality MACO tilt and turn fittings. They are simple and easy to use. Despite this, it is important that you read these instructions carefully to ensure that they are operated and maintained correctly. It is in your own interest that you read these instructions so that any dangers can be avoided!
- ▶ Do keep these instructions handy for future reference. Please ensure that all users are made aware of the contents of these instructions.
- ▶ Check that you have the operating instruction sticker, more importantly has it been attached to the window?
- ▶ Following these instructions will ensure that your windows remain in a good working condition for years to come.

Operating Tilt and Turn Windows



Position for cleaning or for a short period of ventilation. Do not leave the window unattended.

Position for continuous ventilation.

Closed position, advisable if the room is to be unattended for a long period of time.

Special version with a night vent position.



If the window opens or closes on its own due to air pressure or suction special fittings are available to overcome this. These must be fitted by a qualified person.

Installation of the Sash

The removal and installation of the opening sashes are only to be carried out by qualified personnel.

Removal and installation of the sash:

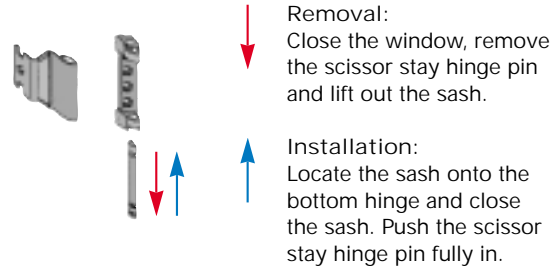

Adjusting the sash lifter: Slacken screw, adjust and re-tighten.

Re-setting the sash lifter:
1. Press the spring with an Allen key.
2. Re-centre the sash lifter.

Should the window become uninged at the top press and hold the sash lifter in the centre position. Then push the sash back into the frame, the handle is now free to move.

Adjusting the window:

Raising or lowering the sash:
Allen key 4 mm.

Scissor stay compression:
Allen key 4 mm.

Bottom corner hinge:
Vertical and horizontal
Allen key 4 mm.

Compression:
Screwdriver or Torx T20 key.

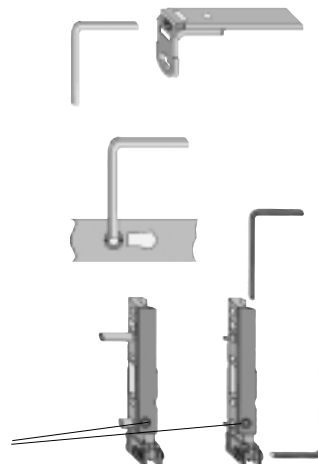

User Information

Do not apply additional loadings to the sash.

Do not force the sash past its opening edge.

Do not put anything between the sash and frame to wedge it open.

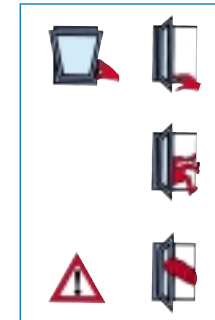
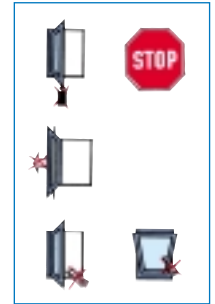

An injury can be caused if you place any part of your body in the opening between the sash and the frame.

Danger of falling out.

Danger of being injured due to the effect of the wind.

General Guidelines for your windows

A good window does more than let in light and air, it is a structural unit which has high technical demands made on it. The fittings must be maintained according to these instructions, coupled with periodical checks of the glass and weather seals etc. Any faulty components should be replaced immediately. We do not recommend the use of caustic cleaning agents to clean your windows, use only water with a mild soap solution.



MAYER & CO. BESCHLÄGE GMBH
Alpenstraße 173, A-5020 Salzburg, Tel.: +43 662 6196-0, Fax: +43 662 6196-101
e-mail: maco@maco.at, <http://www.maco.at>

MACO DOOR & WINDOW HARDWARE (U.K) LTD
Eurolink Industrial Centre, Castle Road, Sittingbourne, Kent ME10 3LY
Tel.: 01795 433900 Fax.: 01795 433901 e-mail: maco@macouk.net, <http://www.macouk.net>

Order-No. 49209 — Date: Oktober 1999

This brochure is the property of MACO. All rights reserved. We reserve the right to make alterations.