

Titon  
CME1  
CME1 *Q Plus*  
Mechanical Extract Ventilation Unit

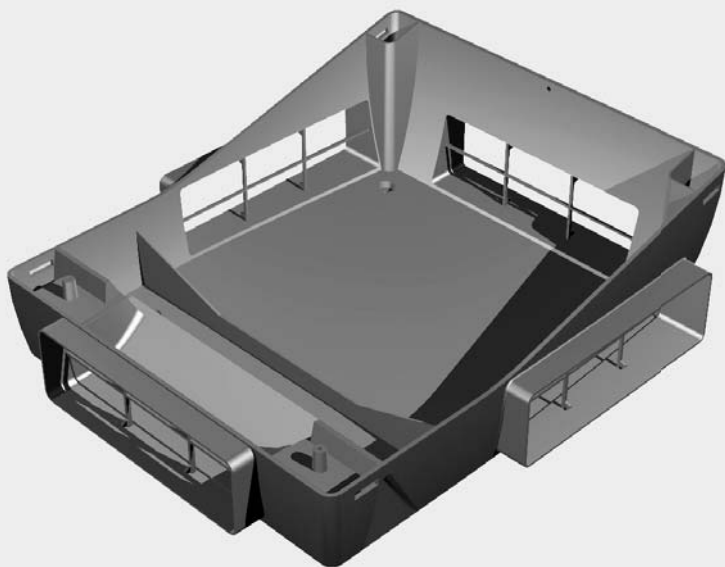

Base Installation Manual

# Important Information

This booklet is required for the first part of an installation of either a Titon CME1 or Titon CME1 Q Plus in a two stage process.

**The installer must be aware which model has been specified before commencing installation.**

**Please Note the CME1 and CME1 Q Plus have different wiring requirements. Ensure the correct wiring diagram is used for your installation. The unit may be damaged if wired incorrectly.**

The installer of the second stage will receive further documentation to complete the installation and commissioning.

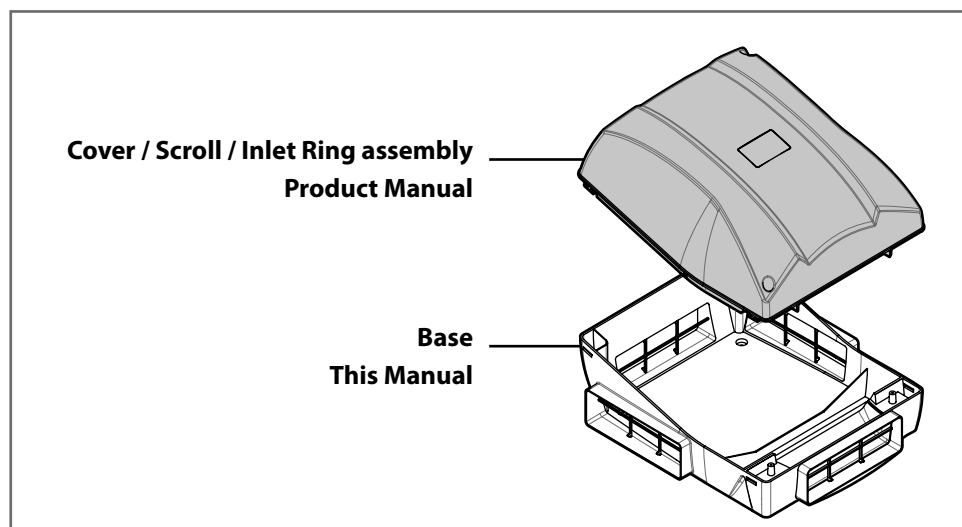

**Component Identification**

## Parts List

- Base Installation Manual x 1
- Base x 1
- Port Covers x 3

## Dimensions

This diagrams shows the overall dimensions of the unit, and the additional space required around the unit once installed to allow for future servicing and maintenance.

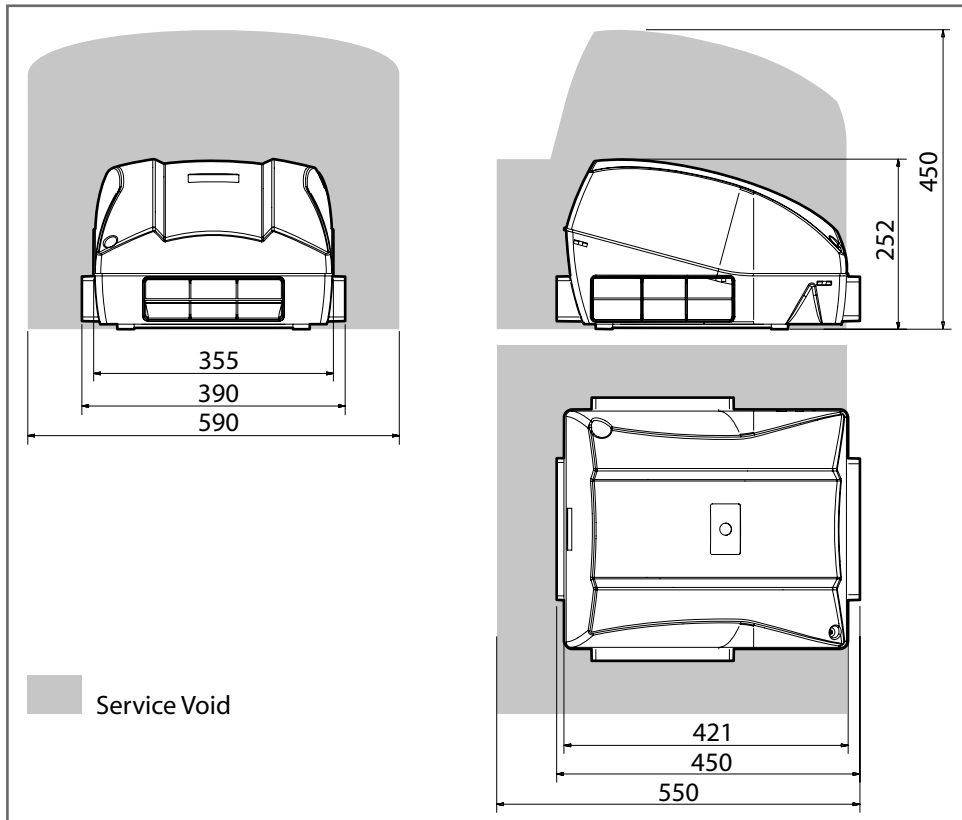

All dimensions in mm

# Installation

## Preparation

**Important: read these instructions fully before the installation of this appliance**

- NEVER install the CME1 in an area which does not have sufficient access for future maintenance (see Dimensions) , or 'box-in' the unit, as the area may subsequently surface finished making access to the unit difficult.
- NEVER install the appliance in an environment which contains:
  - Excessive oil or a grease laden environment.
  - Hazardous gases, liquids or vapours that are flammable or corrosive.
  - Ambient temperatures above 40°C or below -5°C.
  - Humidity levels above 90% or a wet environment.

## Fixing

1. The CME1 must be securely fixed to a smooth flat surface, any orientation is possible.
2. Mark the four fixing hole centres using the BASE as a template
3. Drill holes for fixings, use 4mm Pan Head screws. Always use a fixing type and length suited to the substrate type. The unit weighs approximately 5kg.
4. It is important that the BASE is mounted so that it is not distorted by the fixings or mounting surface, distortion of the BASE may result in difficulty in fitting the Cover / Scroll / Inlet Ring assembly (2nd Fix).

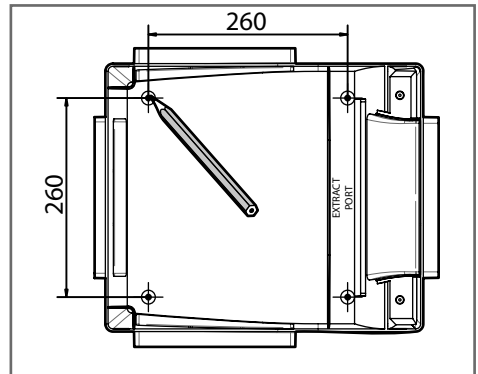

**Do not use power tools to tighten screws. Tighten screws by hand.**

**Do not over tighten screws.**

## Ducting Best Practice

- The use of flexible ducting must be kept to a minimum and it should always be pulled taut.
- If applicable, Fire Dampers must be fitted to duct work at appropriate locations in accordance with Building Regulations.
- Ducting must be installed in such a way that resistance to airflow is minimised.
- Ducting terminal for Exhaust must be to the external air outside the building envelope.
- Ducting in unheated spaces must always be insulated to prevent condensation forming within the ducting.
- Additional guidance can be found in the Residential Ventilation Association Installation Good Practice Guide and Approved Document Part F.

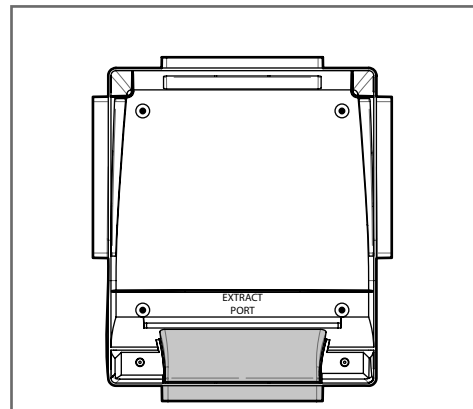

**Extract Port to Outside**

# Installation

## Ducting Connection

- 204mm x 60mm ducting fits inside the ports.
- To enable fitment of 110x54mm ducting, modify the convertible port cover by tearing out the 'rip strip'.
- When using the convertible port cover ensure the tear out section is completely removed.

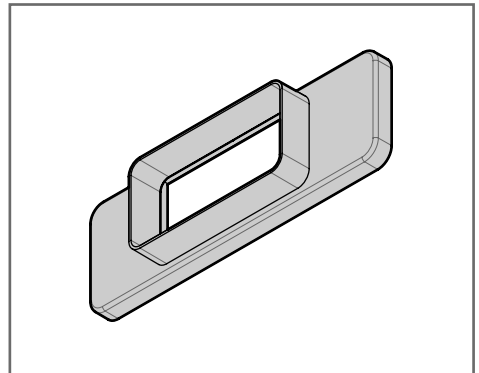
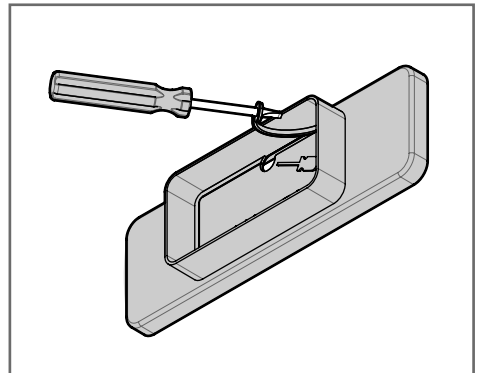
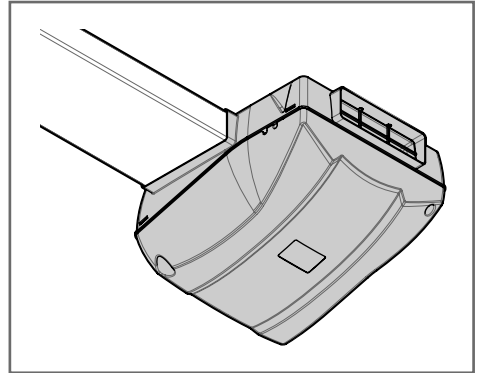

## Ducting Connection

- 110mm x 54mm ducting fits inside the convertible port cover

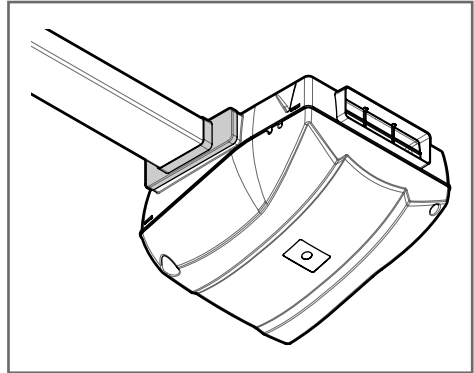

- All joints must be adequately sealed, on all sides, using a suitable ducting tape and/or silicone type sealant.

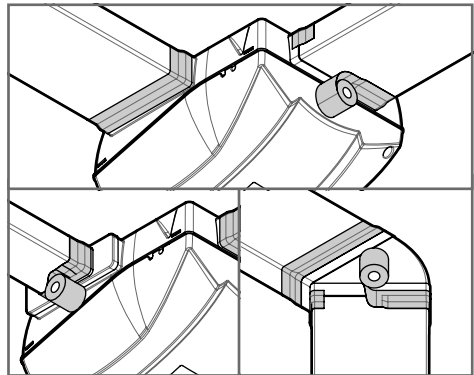

- Unused extract ports must be fitted with non-converted or undamaged port covers.

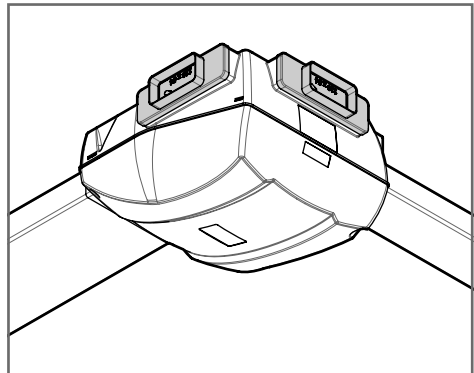

# Installation

**The installer must be aware which model has been specified before commencing installation.**

**Please Note the CME1 and CME1 Q Plus have different wiring requirements. Ensure the correct wiring diagram is used for your installation. The unit may be damaged if wired incorrectly.**

**WARNING: The unit MUST be earthed. All wiring must conform to current I.E.E. Wiring Regulations and all applicable standards and Building Regulations.**

## CME1 Wiring

- The unit is suitable for 230V~50/60Hz Single phase supply fused at 3A.
- For connection of the mains and boost trigger switch a terminal block is fitted inside the unit, under the COVER. Note: strain relief for the cables is provided.
- A double pole isolation switch with contact separation of at least 3mm must be used to connect the appliance to the fixed wiring.
- A boost switch must be connected for the unit to run, see wiring diagram (a connection is required between COM and L1 or L2 for the unit to operate).
- Boost controls must not be located in a bath/shower room or within 1 metre of a cooker or where they may be affected by excessive heat or moisture.
- Boost controls should be clearly identified and conveniently located.
- The boost can be operated by any device which provides a two-way switch suitable for a 230V/3A mains power supply.
- Cable Access is via the preformed cable entries on the unit COVER, position arrowed

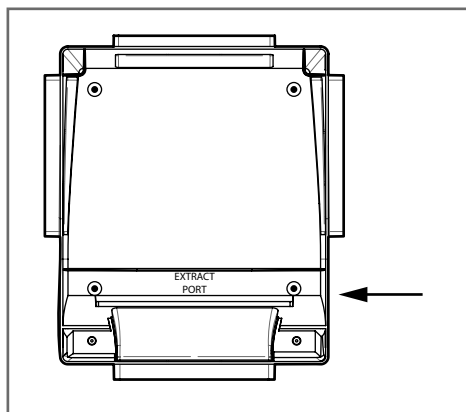

**Cable Entry Position**

## CME1 Wiring

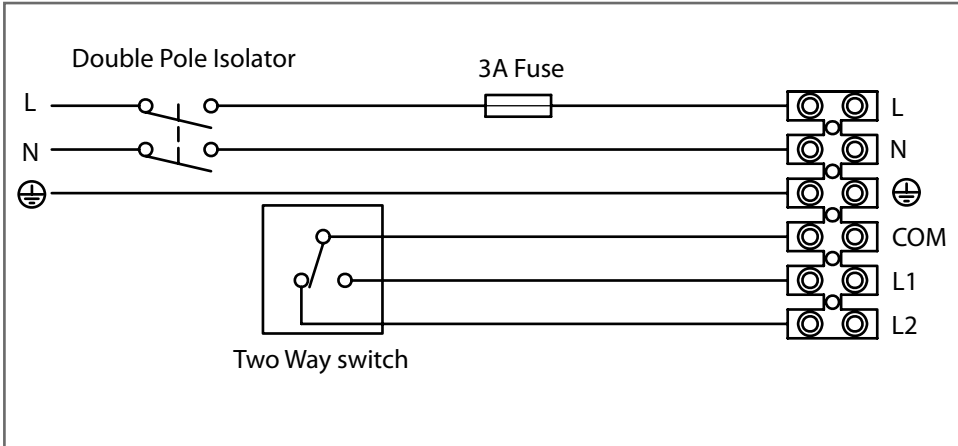

**Wiring Diagram for Continuous and Boost Speeds 1, 2 or 3**

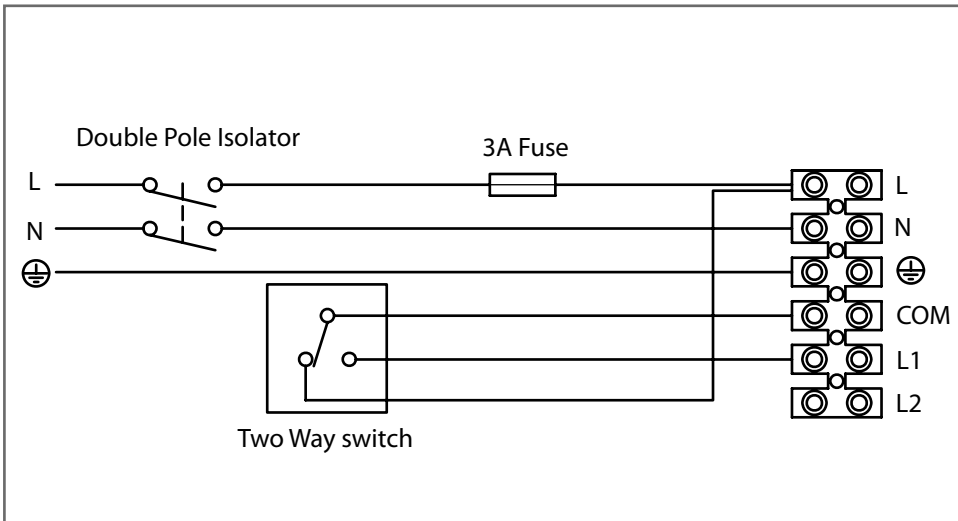

**Wiring Diagram for Continuous Speed 1, 2 or 3 and Boost Speed 4**

# Installation

**The installer must be aware which model has been specified before commencing installation.**

**Please Note the CME1 and CME1 Q Plus have different wiring requirements. Ensure the correct wiring diagram is used for your installation. The unit may be damaged if wired incorrectly.**

**WARNING: The unit MUST be earthed. All wiring must conform to current I.E.E. Wiring Regulations and all applicable standards and Building Regulations.**

## CME1 Q Plus Wiring

- The unit is suitable for 230V~50Hz Single phase supply fused at 3A.
- A double pole isolation switch with contact separation of at least 3mm must be used to connect the appliance to the fixed wiring.
- Boost controls must not be located within 1 metre of a cooker or where they may be affected by excessive heat or moisture
- Boost controls should be clearly identified and conveniently located.
- The boost switch wiring must not be connected to the mains supply.
- The boost switch is connected to the control board (which is located under the COVER on top of the SCROLL).
- The boost delay can be triggered by any device which provides a one-way switch, such as a PIR, thermostat, humidistat or a standard one-way switch.
- The boost facility features a delay timer, so we recommend a sprung-return (momentary) switch is used to prevent the boost being accidentally left on for longer than intended.
- Cable Access is via the preformed cable entries on the unit COVER, position arrowed.

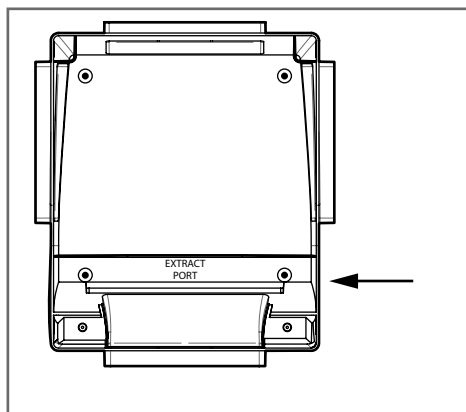

**Cable Entry Position**

## CME1 Q Plus Wiring

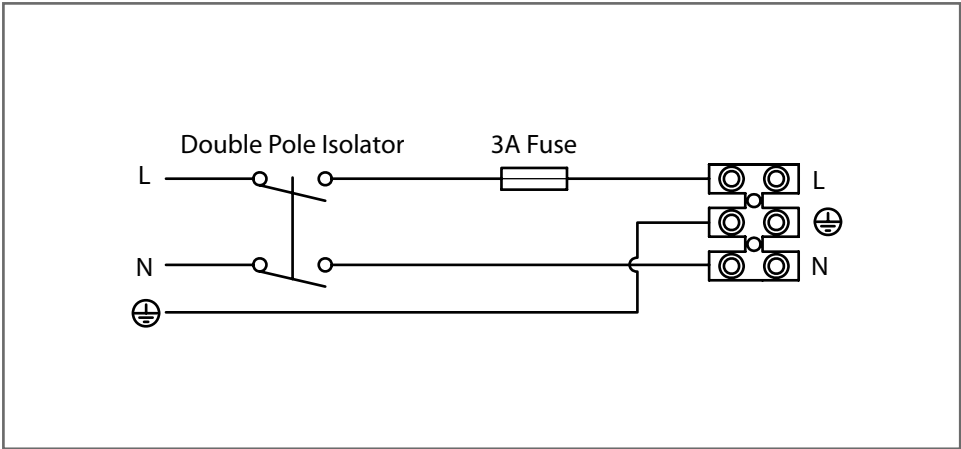

Supply Wiring Diagram 230V~50Hz

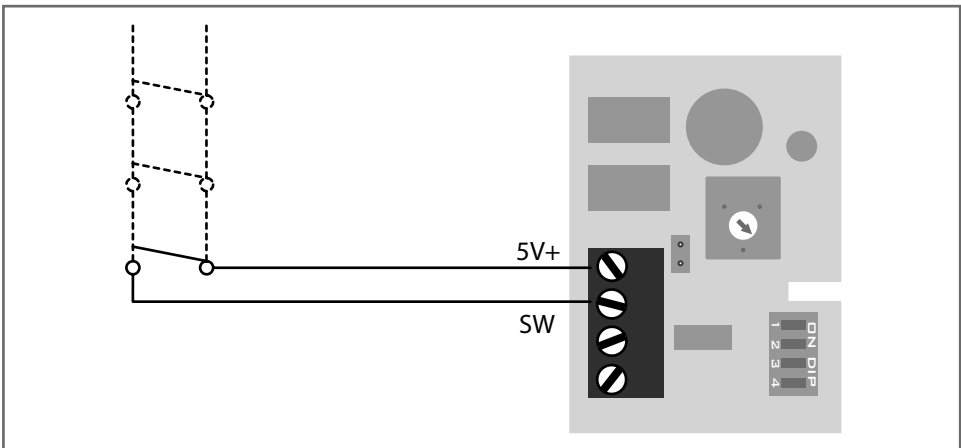

Boost Control Wiring Diagram, Low Voltage Only

Installed by



**MARKETING DIVISION**

International House, Peartree Road, Stanway, Colchester, Essex CO3 0JL

Tel: +44 (0) 1206 713800 Fax: +44 (0) 1206 543126

Email: [ventsystems@titon.co.uk](mailto:ventsystems@titon.co.uk) Web: [www.titon.com](http://www.titon.com)